

NB. renoverat ~~et~~ ~~in~~ ~~du~~ ~~in~~ ~~figu~~ ~~in~~ ~~1681~~  
1737.

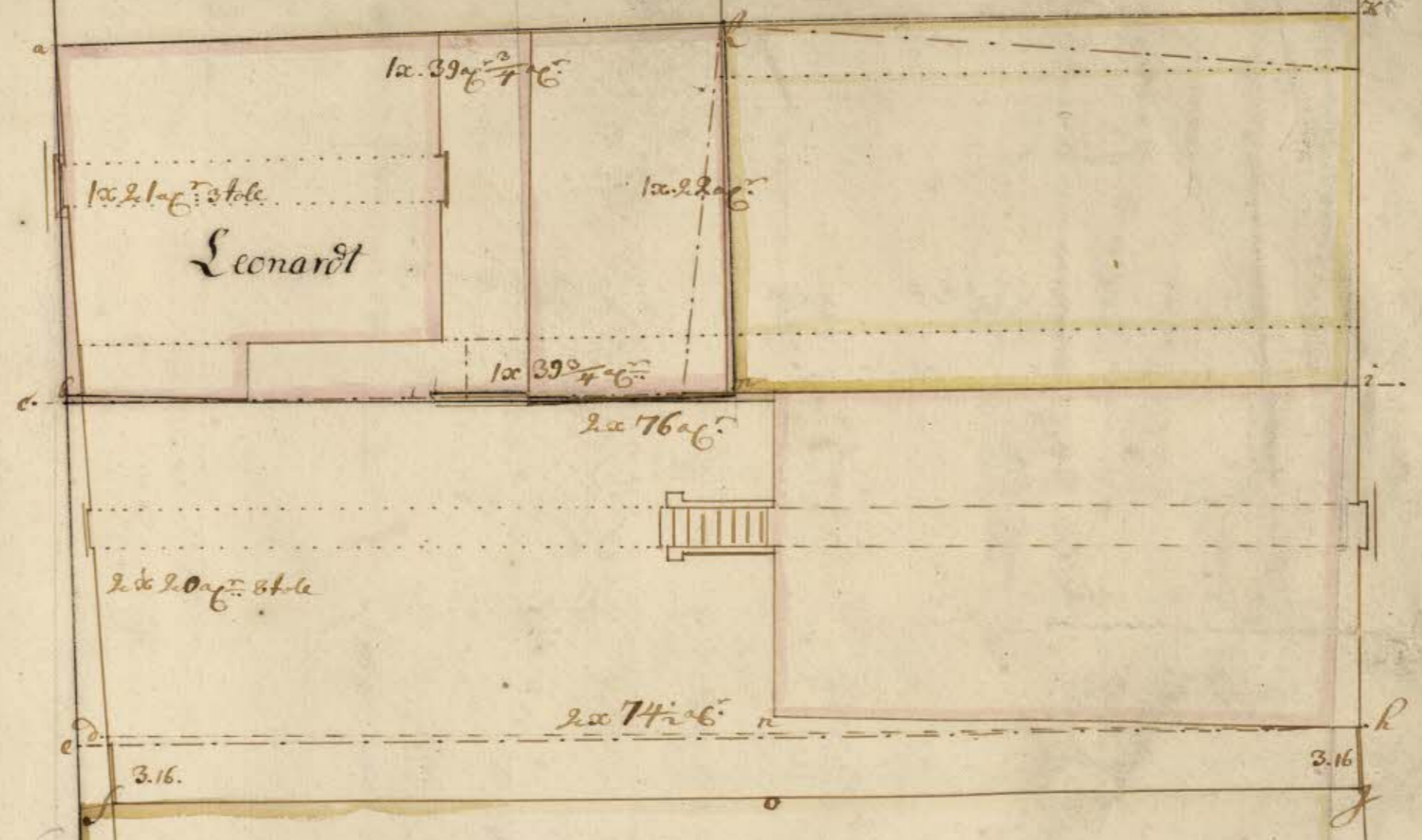

Linea ab. — 21 f  
 bc — 8 tole  
 Lin b d c e 20 f 8 tole.  
 etc.

NB 1a Pinckardt ke Saffebrefvet  
 anno 1680 d 21 Februari  
 2a. Int Hillenbrandiske  
 Profant ad 1647 & 1671.

NB. Linien ei ar den ratta  
 Hyllinien efter Documenterne

2o. Typhon  
 se pag 13.

