

95

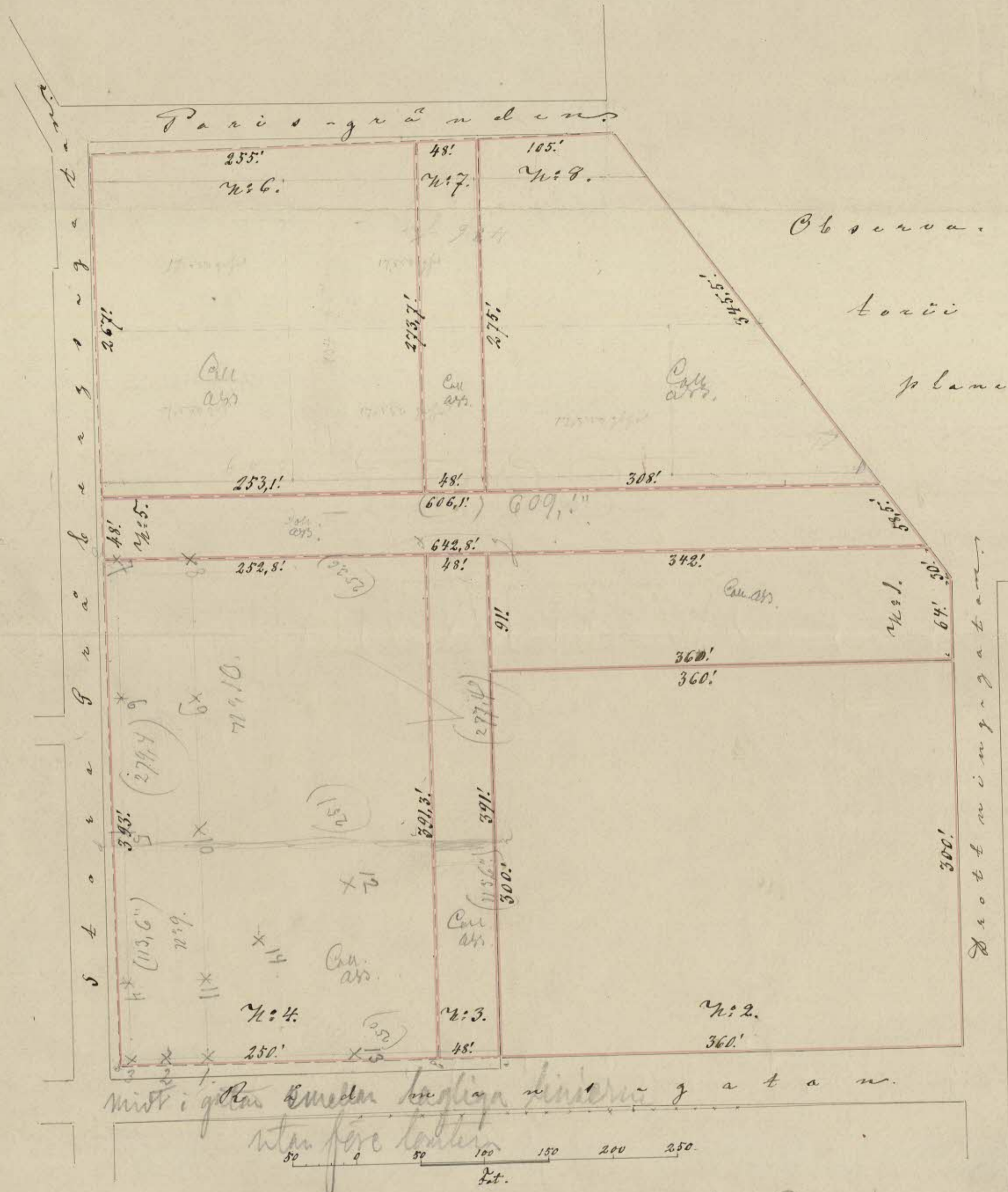

- No. 1 = 31600 qv. fe.
- No. 2 = 108000 " "
- No. 3 = 18770 " "
- No. 4 = 97800 " "
- No. 5 = 29600 " "
- No. 6 = 67820 " "
- No. 7 = 13146 " "
- No. 8 = 56332 " "

Lv. Paris  
1860 - 1870

P-skäpet (Ad. Fr.)

